



Gemini System

The complete flexibility of the Solution™ Series Gemini System (GS1/GS2) will handle a multitude of functions in a laboratory environment with electrical, data and fixtures available in one place. From science and technology to education, there is a configuration to meet your requirements. The Gemini System utilizes quick connect fittings for easy installation and is available in a vast array of sizes and configurations.

so adaptable.

- Wall and island configurations are easily interchangeable for new or renovation projects
- Can be used in conjunction with mobile or floor mounted casework
- Solid welded construction
- Stationary models include a fine-adjust leveling foot
- Static load capacity of 1000 lbs. (on stationary models)
- Overall height is 84"
- Adjustable leg height from 29-36"
- Available in 48, 60 and 72" widths
- Cabinets ordered separately
- Counter top options
- Shelving adjustable in 1" increments
- Electrical raceways
- Up to three plumbing services

Air Master Systems Corp.

6480 Norton Center Drive, Muskegon, MI 49441 • 231.798.1111 • 231.798.4000 fax • airmastersystems.com



Gemini System GS1 single-sided



48" wide



60" and 72" widths (with intermediate support)

Air Master Systems Corp.

6480 Norton Center Drive, Muskegon, MI 49441 • 231.798.1111 • 231.798.4000 fax • airmastersystems.com

© 2016 Air Master Systems Corp

Gemini System GS2 double-sided



48" wide



60" and 72" widths (with intermediate support)

Air Master Systems Corp.

6480 Norton Center Drive, Muskegon, MI 49441 • 231.798.1111 • 231.798.4000 fax • airmastersystems.com

© 2016 Air Master Systems Corp

Gemini System Features

Extended Pre-plumbed

3/8" flexible tubing 3' or 6' above top of post.

Pre-wired Pigtail

Extending 3' or 6' above top of post with straight-blade or twist-lock plug.

Split Shelving

Available up to 16" depth for 60" and 72" units with center support. Available with bookends or inverted brackets. (Bookends shown with seismic rods.)

Pre-plumbed

3/8" flexible PVC tubing to top of post.

Full-width Shelving

12" or 16" depth. Maximum 12" depth for 60" and 72" units. Available with bookends or inverted brackets. (Bookends shown with seismic rods.)

Electrical Raceway

One- or two-sided with any combination of 20 amp, 120 VAC. Standard, GFCI or USB receptacles.

Data Outlets

Twin CAT6 outlets placed opposite of service fittings.

Service Valves

Dual or single ball-valve. 3 fittings maximum.

Lower Post Electrical (Included)

20 amp, 120 VAC. Standard, GFCI or USB receptacle.

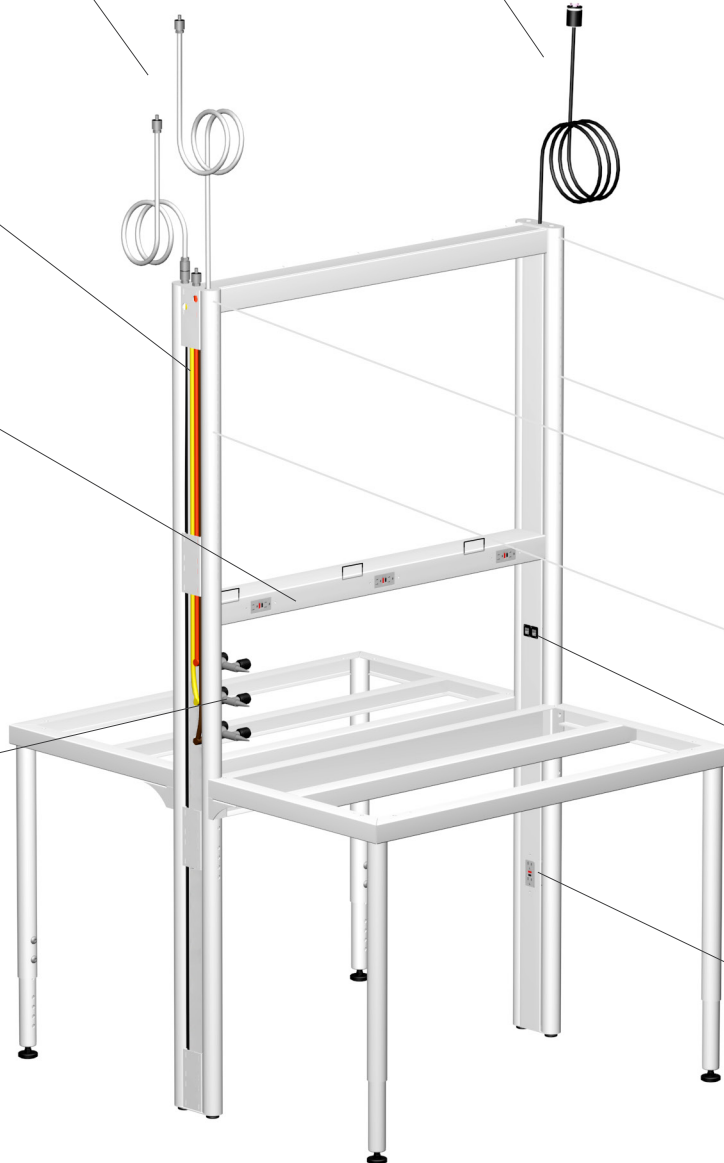

Air Master Systems Corp.

6480 Norton Center Drive, Muskegon, MI 49441 • 231.798.1111 • 231.798.4000 fax • airmastersystems.com